



GENESIS REVOLUTION Quick Start Instructions

Unpacking / Inspection

Be sure to check your entire water softener shipment for any possible damage that could have occurred in transit. You should have received a resin tank with resin inside and a temporary shipping cap on top. A brine tank assembled with a control valve box inside. Depending on what you added your order there may be additional parts or drain tubing included. If you feel there is an issue with your order, email us at sales@discountwatersofteners.com and someone will assist you right away. Your water softener control valve may have residual water inside from manufacturer QC check and the controller may show regeneration already performed by the controller and gallons registered as part of the manufacturer QC program. Small parts, needed to install the softener, are in a parts bag. To avoid loss of the small parts, keep them in the parts bag until you are ready to use them.

Upon startup your control valve will not give you a backwash step as part of the water savings of the system. We suggest advancing your water softener to the RINSE stage upon startup to rinse the resin clean. After that you can go back and perform your full regeneration.

Installation & Start Up

1. Install unit as per local plumbing codes. (Refer to detail instructions in Owners Manual) Avoid pinched o-rings during installation by applying (provided with install kit) NSF certified lubricant to all seals. Be sure to leave the unit in the "BYPASS" position. Attach upper screen cone to underside of control valve.
2. Connect the drain line to the valve.
3. Connect the brine line from the valve to the air check / safety elbow. Double check to make sure all connections are assembled correctly and the brass and plastic nuts are tight and secure to prevent leaks. Be sure to install the tube insert in the brine tubing before connecting the brine tube to the control valve.
4. Add at least 5 gallons of water to the brine tank.
5. Add at least 1 bag (about 40lbs of water softener salt) to the brine tank.
6. Plug the power transformer into an approved power source. Connect the power cord to the valve. When power is supplied to the control, the screen may display "INITIALIZING WAIT PLEASE" while it finds the service position.
7. Press MENU scroll down to Regeneration. Select and scroll to NOW and press set. That will initiate a regeneration.
8. Once in the REGENERATION cycle, open the inlet on the bypass valve slowly and allow water to enter the unit. Allow all air to escape from the unit before turning the water on fully then allow water to run to drain for 3-4 minutes or until all media fines are washed out of the softener indicated by clear water in the drain hose.
9. Press any button to advance to the RINSE position. Check the drain line flow. Allow the water to run for 3-4 minutes or until the water is clear.
10. Press any button to advance to the REFILL position. Check that the valve is filling water into the brine tank. Allow the valve to refill for the full amount of time as displayed on the screen to insure a proper brine solution for the next regeneration.
11. The valve will automatically advance to the SERVICE position. Open the outlet valve on the bypass, then open the nearest treated water faucet and allow the water to run until clear, close the tap and replace the faucet screen.
12. Program unit.



Figure 1. Key Pad Configuration

Programming Guide

Press the MENU key to enter the programming menu. Scroll UP or DOWN to get to the item you need to adjust. Press SET to select the value you need to adjust.

TIME OF DAY
12:01 PM

SET TIME/DATE

This value should be selected and time/date to the appropriate time and date. Be sure to hit SET after setting your values.

YEAR
2012

SET HARDNESS

This value is the maximum compensated water hardness in grains per gallon of the raw water supply. It is used to calculate the system capacity. If Ferrous Iron is present add 5 gpg for every 1 ppm of Ferrous Iron.

MONTH
AUGUST

DAY
21

SET HARDNESS
20 GRAINS

After all installation and programming is complete, wait 6 hours and then perform a manual regeneration to get soft water.

Installation

- Place the softener as close as possible to the pressure tank (well system) or water meter (city water) and a floor drain or other acceptable drain point (laundry tub, sump, standpipe, etc.).
- Connect the softener to the main water supply pipe **BEFORE** the water heater. **DO NOT RUN HOT WATER THROUGH THE SOFTENER.** Temperature of water passing through the softener must be less than 100 deg. F.
- Keep outside faucets on hard water to save soft water and salt.
- Do not install the softener in a place where it could freeze. Damage caused by freezing is not covered by the warranty.
- Put the softener in a place water damage is least likely to occur if a leak develops. The manufacturer will not repair or pay for water damage.
- A 120 volt electric outlet, to plug the included transformer into, is needed within 6 feet of the softener. Be sure the electric outlet and transformer are in an inside location, to protect from wet weather.
- If installing in an outside location, you must take the steps necessary to assure the softener, installation plumbing, wiring, etc., are as well protected from the elements, contamination, vandalism, etc., as when installed indoors.
- Keep the softener out of direct sunlight. The sun's heat may soften and distort plastic parts.

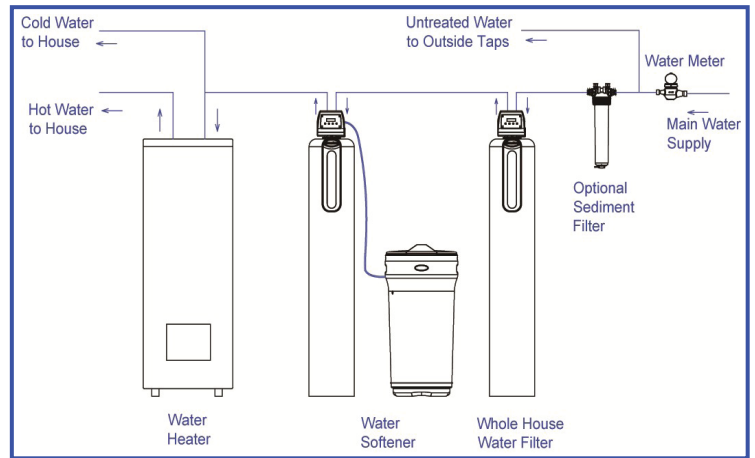

Cabinet

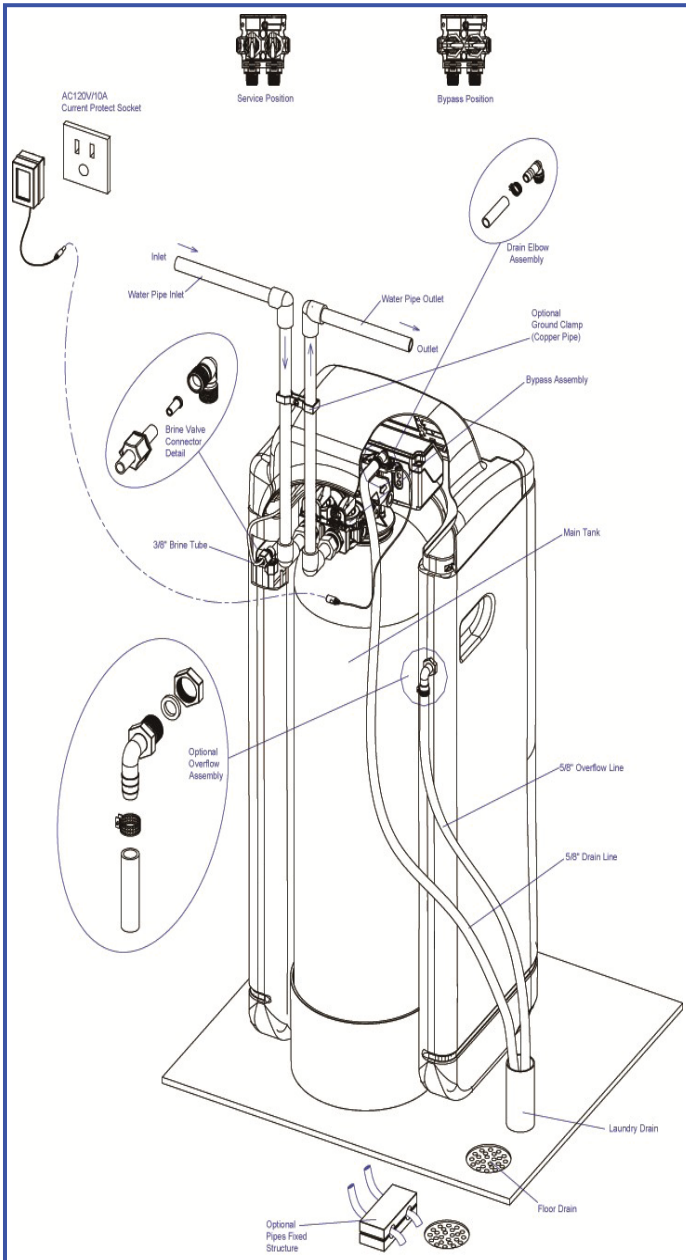

Twin Tank

